

Assembly Instructions

Supporting pole/flag assembly

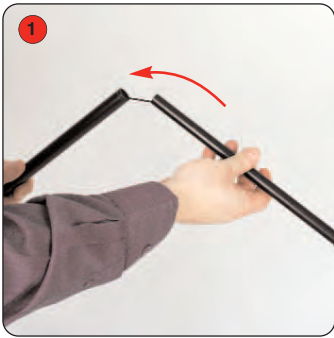

Assemble the bungee corded poles together.

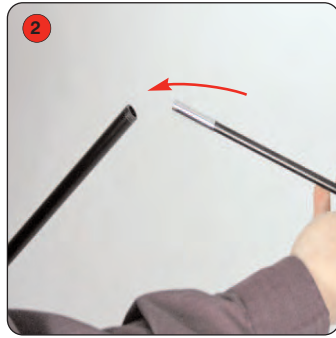

Insert the middle sized GRP rod into the bungeed poles.

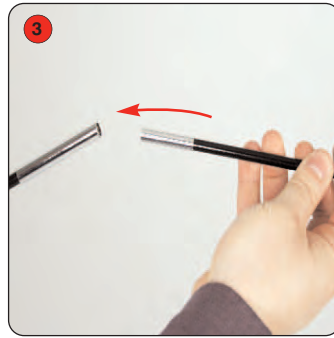

Insert the smallest diameter GRP rod.



Feed the pole assembly (thinnest end first) into the flag pocket. **Warning: take care not to damage the pocket when inserting the rods/poles.** Bend the GRP rods to allow the flag to take shape.



Attach the looped fabric end of the flag to the pole clasp.



Fit the base adaptor to the assembled poles.



Base foot and weighting ring option



Open out the base foot.



Place the base foot on the ground.



Fill the weighting ring with water (hosepipe recommended) and place over the base foot.

Warning: Do not drop the weighting ring.



Fit the supporting pole/flag assembly into the base foot.

Ground stake option



Push the the ground stake firmly into the ground.



Insert the supporting pole/flag assembly into the ground stake.

Drive-on car foot option



Drive vehicle onto the car-foot .



Insert the supporting pole/flag assembly into the car-foot